

INSTITUTE OF TECHNOLOGY, KORBA(C.G.)  
CIVIL ENGINEERING DEPARTMENT MAINTENANCE WORK  
PROPOSED BUDGET 2017-18

S.NO.	DESCRIPTION	ESTIMATED COST (Rs. IN LAKH)
1	Annual maintenance of pipe fitting & sanitary work	1.00
2	Partition work of SED Lab	1.00
3	Foundation work of civil Engg. Laboratory Equipment i) Concrete Lab ii) Geotech Lab iii) Geotech & transportation Engg. Lab iv) Fluid Mechanics Lab	2.00
4	Painting of walls, exterior wall of building	4.00
5	Remp for specially abled person length 152' height 13' width 5' with side supports. As per BIS norms	4.00
6	Foundation work of Mechanical Engg. Laboratory Equipment	1.00
7	Foundation work of Electrical Engg. Laboratory Equipment	1.00
8	All drop & Door Fitting, sanatory & Pipe fitting	1.00
Total		15.00
Total Rs. 15.00 Lakh (In Words Fifteen Lakh Only)		

Note: Budget includes the adjustment of budget proposed for session 2016-17 wich has not been used till date.



  
Prepared  
By

  
Checked By

  
HOD  
Civil Engg. Deptt.

INSTITUTE OF TECHNOLOGY, KORBA  
 CIVIL ENGINEERING DEPARTMENT  
 CIVIL ENGINEERING MAINTENANCE WORK

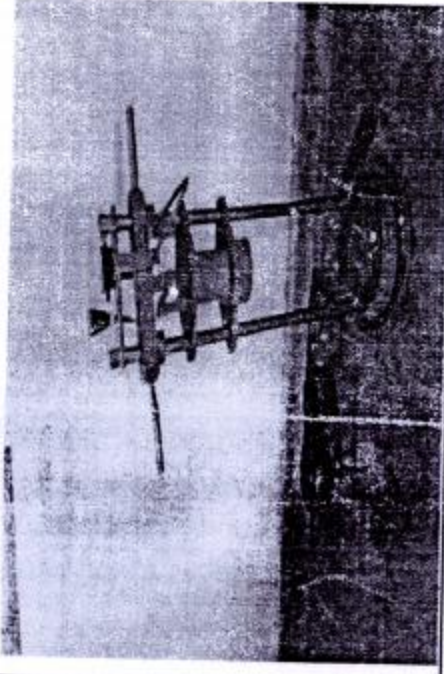
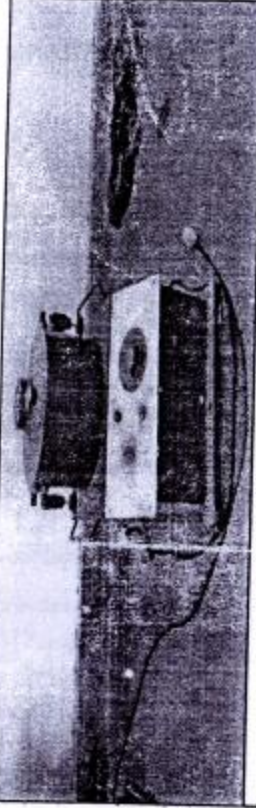
P-2  
 1

S.No	Nature of Work	Name of Lab	Machine /Specification	Type of Foundation	Size of Foundation(in mm)	Size of Foundation(in mm)
1	Foundation Work Either by brickwork/PCC /RCC and eye bolt foundation or by using antivibration mounting pad whichever will be suitable.		Aggregate Impact Test Apparatus	Circular	400 $\phi$	
2			Bitumen Extractor	Rectangular	500X 600	
3			Sieve Shaker Apparatus	Rectangular	400 X 800	

*Prasad*

*Train*

P-43/c  
 P-33/c

P-12

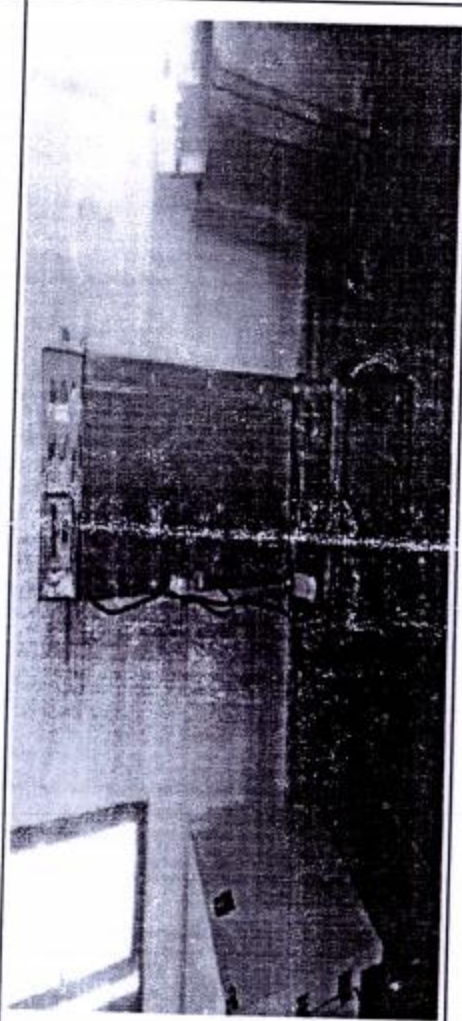
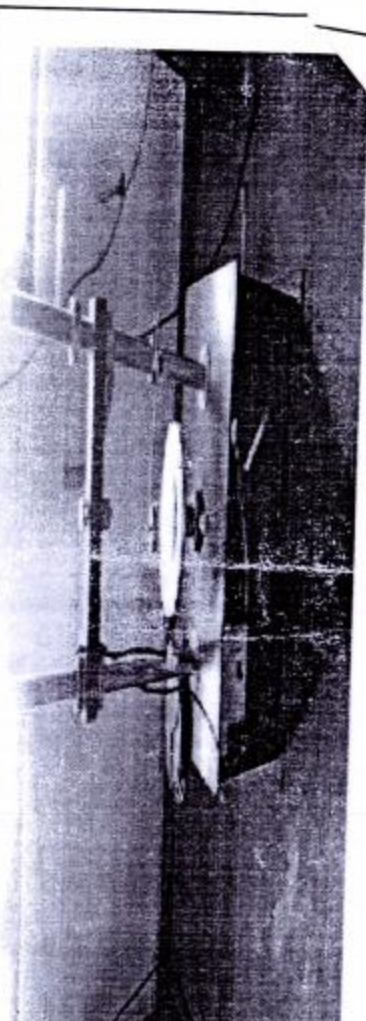
4	Aggregate Abrasion Machine (Devals Apparatus)	Rectangular		700 X 2000
5	Automatic Compactor Machine	Rectangular		500 X 900
6	Geotech Engineering Lab CBR Test Machine-I	Rectangular		600 X 700

*[Handwritten signature]*

*[Handwritten notes]*



P-45/c

7

8

9

CBR Test Machine-  
II

Rectangular

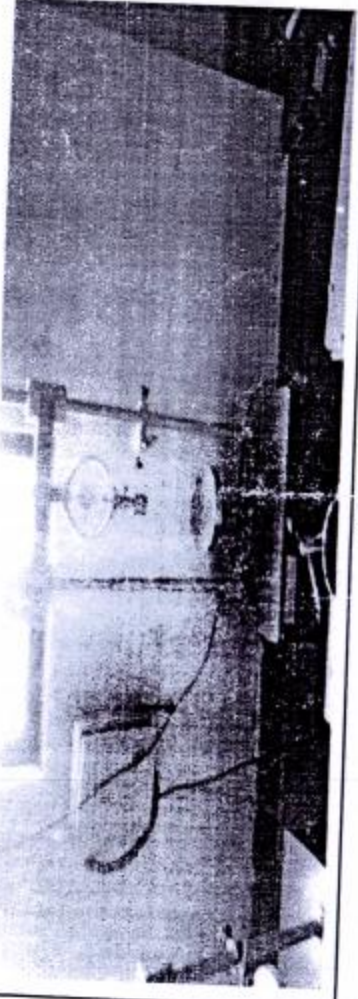

600 X 700

Los Angeles  
Abrasion Machine

Rectangular



700 X 900

Marshal Stability  
Test Apparatus

Rectangular

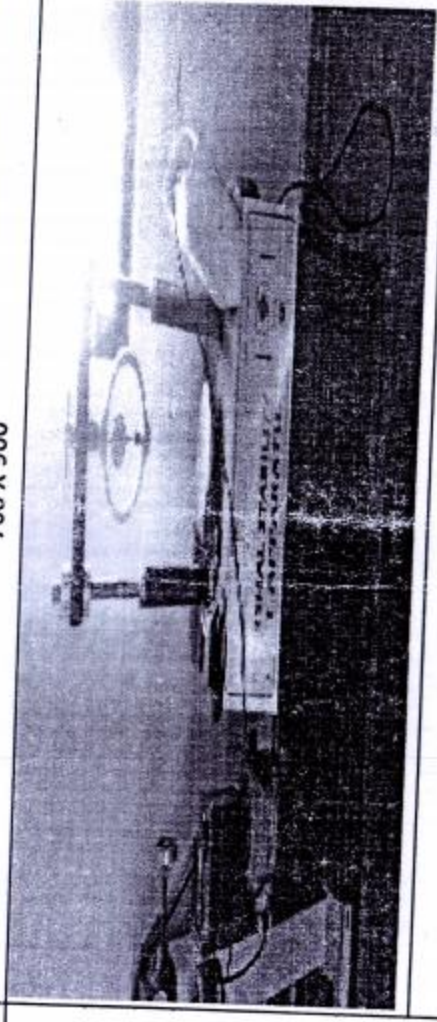

600 X 700

*[Handwritten signature]*

*[Handwritten initials]*

*[Handwritten signature]*

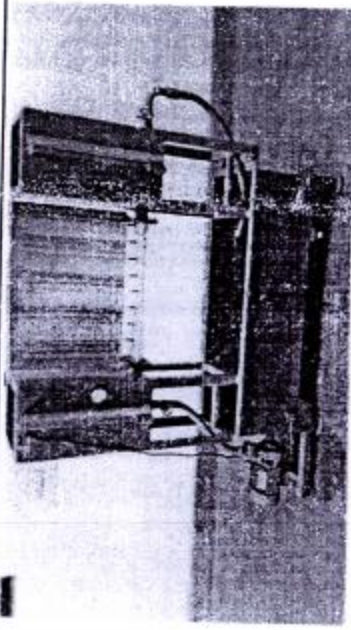
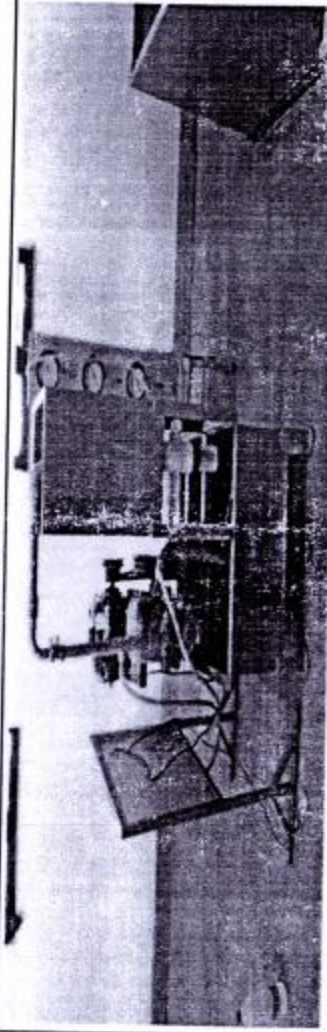
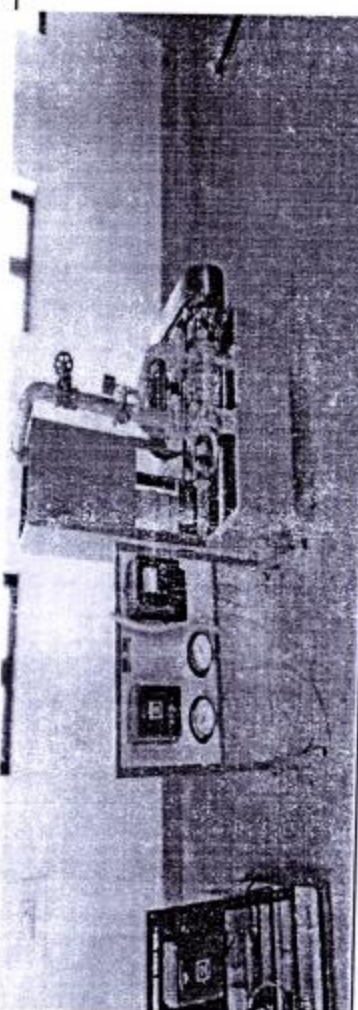

6

	Rectangular	Bernoulli Apparatus
	Square	Reciprocating Pump Test Rig
700X700	Rectangular	
	Square	Multistage centrifugal pump test Rig
700X700	Rectangular	
400 X 600	Rectangular	

17

18

19

20



21

8-48/c  
8-35/c

AB

for

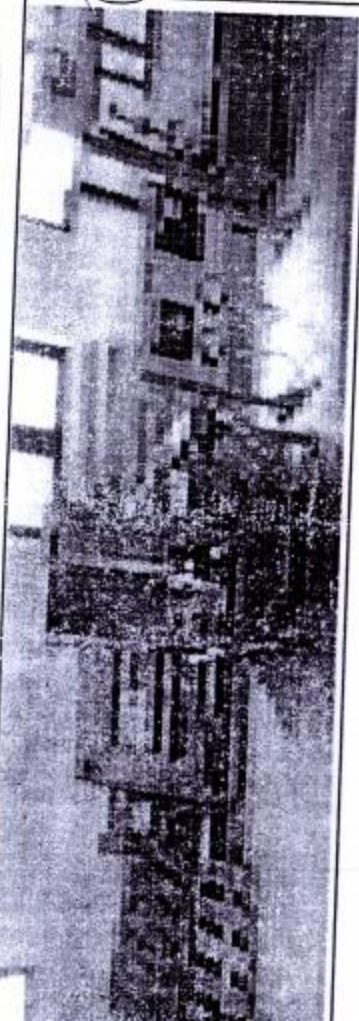
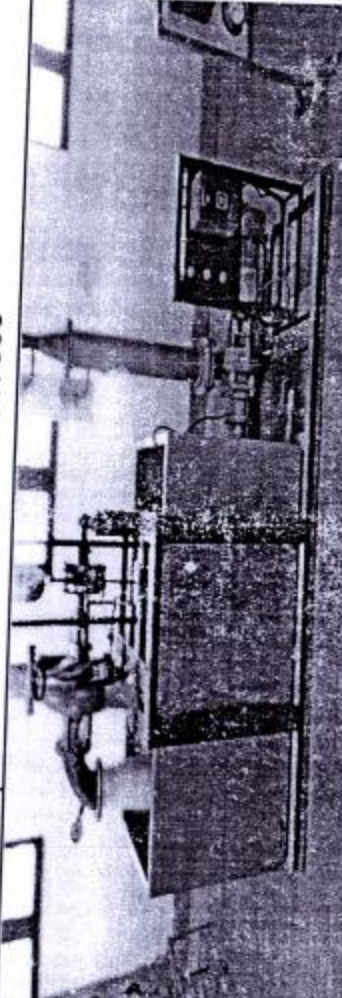
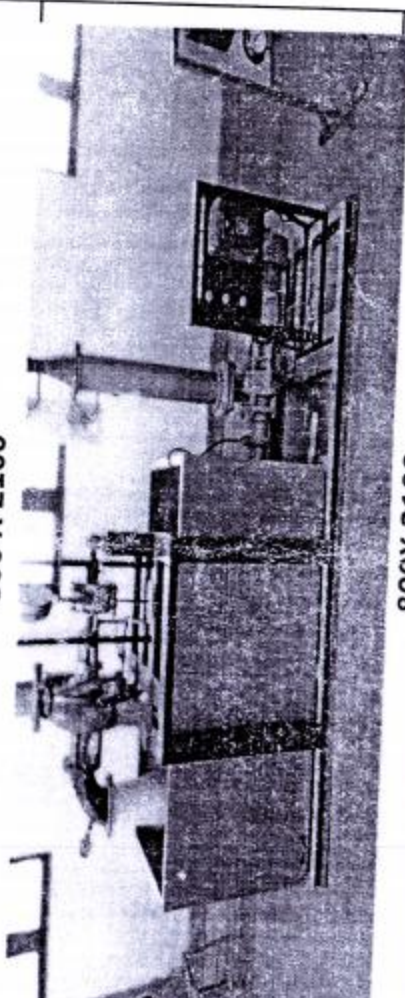
✓  
✓  
✓

	22	23	24	25
Fluid Mechani cs Lab				
Centrifugal Pump Test Rig	Rectangular	Rectangular	Rectangular	Square
Square	700X700	400 X 600	800 X 2100	800X 2100
				

8-49/c  
1-50/c





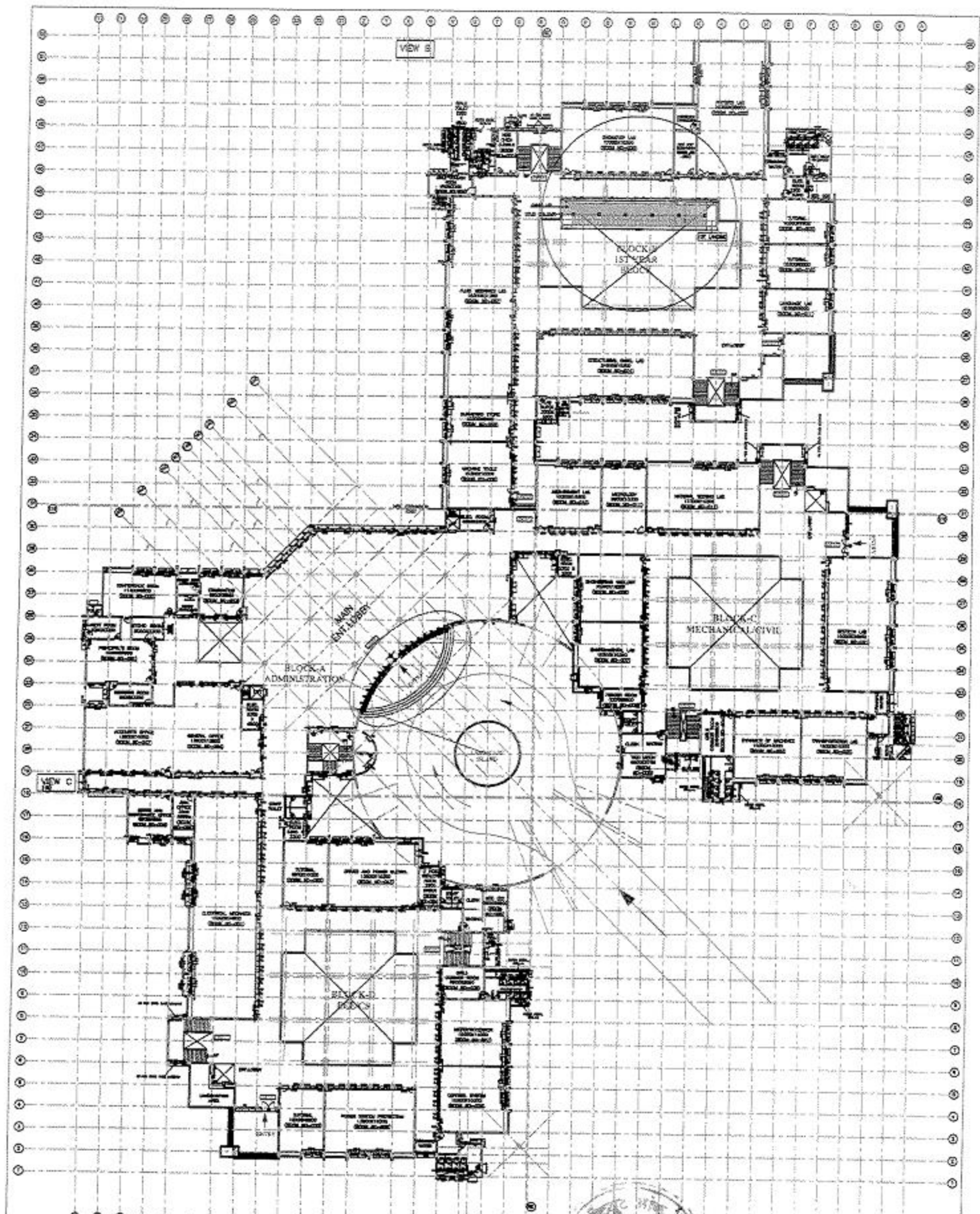

VIEW B

BLOCK-A  
ADMINISTRATION

BLOCK-B  
1ST YEAR  
BLOCK

BLOCK-C  
MECHANICAL/CIVIL

BLOCK-D  
BLOCK C

Sl. No.	Description	Quantity	Unit	Rate	Total
1	...	...	...	...	...
2	...	...	...	...	...
3	...	...	...	...	...
4	...	...	...	...	...
5	...	...	...	...	...
6	...	...	...	...	...
7	...	...	...	...	...
8	...	...	...	...	...
9	...	...	...	...	...
10	...	...	...	...	...
11	...	...	...	...	...
12	...	...	...	...	...
13	...	...	...	...	...
14	...	...	...	...	...
15	...	...	...	...	...
16	...	...	...	...	...
17	...	...	...	...	...
18	...	...	...	...	...
19	...	...	...	...	...
20	...	...	...	...	...
21	...	...	...	...	...
22	...	...	...	...	...
23	...	...	...	...	...
24	...	...	...	...	...
25	...	...	...	...	...
26	...	...	...	...	...
27	...	...	...	...	...
28	...	...	...	...	...
29	...	...	...	...	...
30	...	...	...	...	...
31	...	...	...	...	...
32	...	...	...	...	...
33	...	...	...	...	...
34	...	...	...	...	...
35	...	...	...	...	...
36	...	...	...	...	...
37	...	...	...	...	...
38	...	...	...	...	...
39	...	...	...	...	...
40	...	...	...	...	...
41	...	...	...	...	...
42	...	...	...	...	...
43	...	...	...	...	...
44	...	...	...	...	...
45	...	...	...	...	...
46	...	...	...	...	...
47	...	...	...	...	...
48	...	...	...	...	...
49	...	...	...	...	...
50	...	...	...	...	...



**GROUND FLOOR PLAN**  
 MODERN CONSULTANTS  
 157/A, KOLKA ROAD, KOLKA, (W.A.)  
 2, ANANDA BHAWAN, RAIPUR, (O.A.)

REVISION	DATE	BY	CHKD	REASON

PROPOSED ACADEMIC & ADMINISTRATIVE BUILDING FOR INSTITUTE OF TECHNOLOGY, KOLKA, CHHATTISGARH

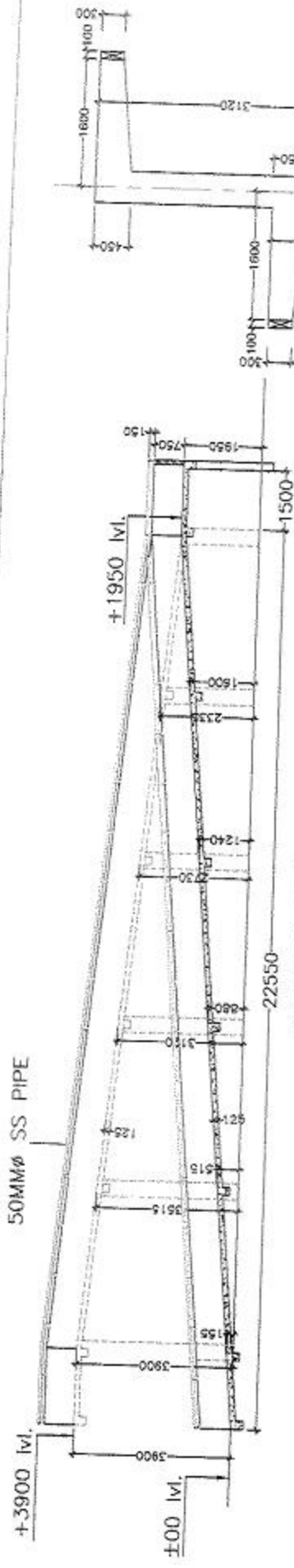

SECTION AT A-A

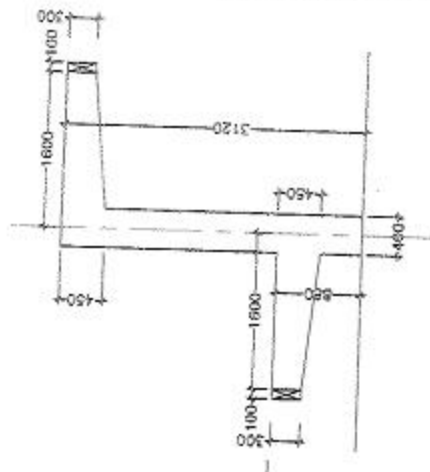

SECTION AT B-B

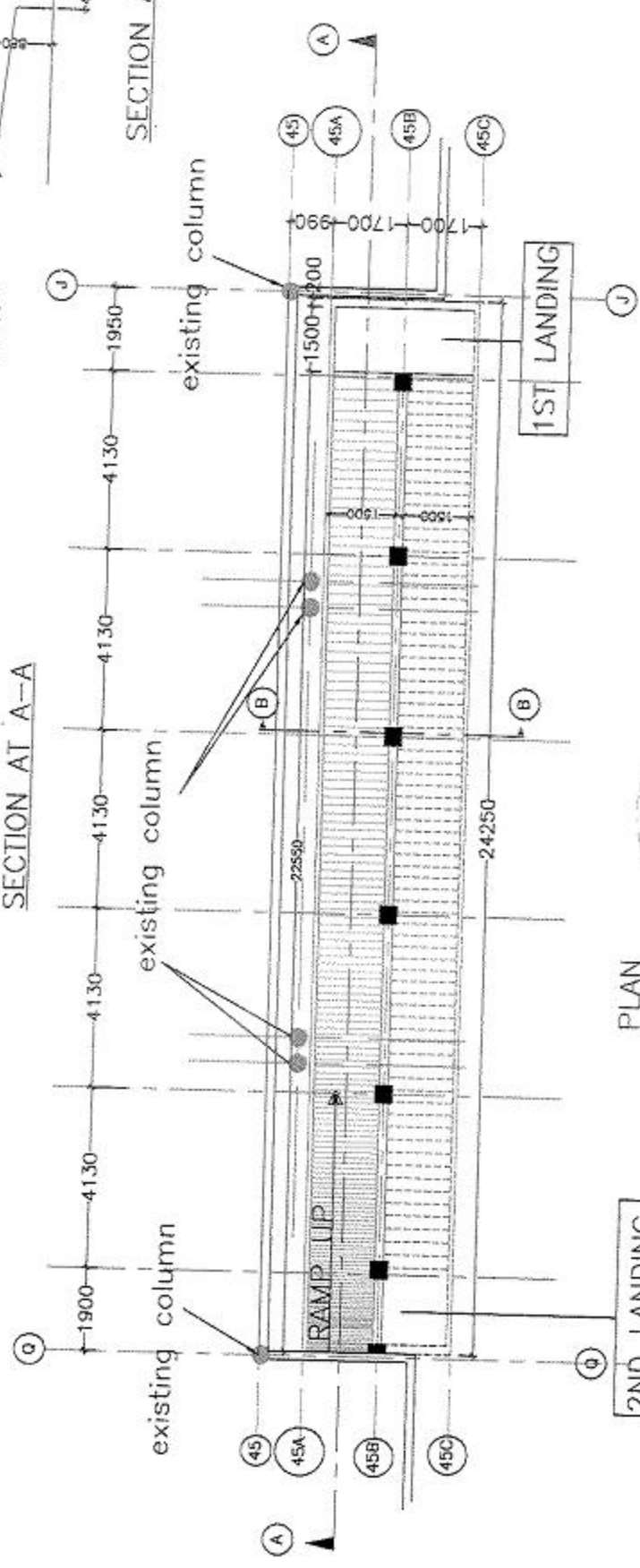

PLAN



RAMP DETAIL

PROPOSED ACADEMIC CUM ADMINISTRATIVE BUILDING FOR INSTITUTE OF TECHNOLOGY, KORBA, CHHATTISGARH

MODERN CONSULTANTS  
12/16, NEHRU NAGAR(CAST), BHILAI. (C.G.)  
9, ASHIRWAD BHAWAN, RAIPUR. (C.G.)

architect: r.k.patel

**ABSTRACT FOR THE CONSTRUCTION OF RAMP AT I T KORBA, CHHATTIS**

S.No	SOR NO.	ITEM DESCRIPTION	QUANTITY	UNIT
<b>EARTH WORK</b>				
1	1.1	Excavation for all types and sizes of foundations, trenches and drains or for any other purpose including disposal of excavated stuff upto 1.5 m lift and lead upto 50m (at least 5m away from the excavated area), including dressing and leveling of pits.		
	1.1.1	In all types of soils. FOR COLUMN FOUNDATION	75.00	CUM.
	1.1.2	In ordinary rocks. FOR COLUMN FOUNDATION	18.75	CUM.
2	1.18	Providing and filling in plinth with sand/ Crusher dust and hard moorum under floor in layers not exceeding 20cm in depth consolidating each deposited layer	74.53	CUM.
<b>FORM WORK</b>				
3	2.1	Providing and fixing form work including centring, shuttering, strutting, staging, propping bracing etc. complete and including its removal at all levels, for:		
	2.1.1	Foundations, footings, bases of columns plinth beam, curtain wall in any shape and size and all type of wall below plinth level.	55.56	SQM.
	2.1.4	Edge of slab, breaks in floor and walls upto 200mm.	106.80	M
	2.1.5	Columns, Pillars, Piers and likes- rectangular or square in shape	82.20	SQM.
	2.1.7	Suspended floors, roofs, access platform, balconies (plain surfaces) and shelves (cast in situ)	85.00	SQM.
	2.1.8	Beams, lintels, cantilevers & walls	114.58	SQM.
<b>CEMENT CONCRETE</b>				
4	3.1	Providing and laying nominal mix plain cement concrete with crushed stone aggregate using concrete mixer in all works upto plinth level excluding cost of form work.		
	3.1.2	1:4:8 (1 cement : 4 coarse sand : 8 graded stone aggregate 40mm nominal size).	4.23	SQM.
5	3.3	Providing and laying design mix reinforced cement concrete with crushed graded stone aggregate 20mm nominal size using batching plant, transit mixer and concrete pump, in all works upto plinth level excluding cost of form work.		
	3.3.2	M-25 Grade	62.94	CUM.
6	3.12	Providing and placing in position reinforcement for R.C.C. work including straightening, cutting, bending, binding etc. complete as per drawings including cost of binding wire in foundation and plinth all complete:		
	3.12.2	Thermo-Mechanically treated bars FE 500D	7552.61	KG
<b>BRICK WORK</b>				
7	7.5	Brick work with modular fly-ash lime bricks (FaLG Bricks) conforming to IS:12894-2002 of class designation 4.0 in oundation and plinth in:		
	7.5.4	Cement Mortar 1:6 (1 Cement : 6 Coarse Sand)	15.26	CUM.
8	7.6	Extra for brick work in superstructure above plinth level for every floor or part thereof in addition to rate for foundation and plinth:	13.49	CUM.
9	7.11	Half brick thick brick masonry with fly-ash lime bricks (FaLG Bricks) conforming to IS:12894-2002 of class designation 4.0 in superstructure above plinth level upto plinth level:		
	7.11.2	Cement Mortar 1:4 (1 cement : 4 coarse sand)	30.00	SQM.
10	7.12	Extra for half brick work in superstructure above plinth level for every story or part thereof in addition to rate for upto plinth level:	30.00	SQM.



		ITEM DESCRIPTION	QUANTITY	UNIT
<b>STEEL &amp; ALUMINIUM WORK</b>				
11	9.3	Steel work in tubular (round, square or rectangular hollow tubes etc.) structure in built-up sections, trusses and frame work including cutting, hoisting, fixing in position upto a height of 5m above plinth level, consisting of columns trusses, roof and bottom purlins, base plate, holding down bolts, wind ties bracing (if required), bolts, nuts and washers for fastening etc. complete with applying a priming coat of red oxide zinc chromate primer.		
	9.3.2	Electric resistance or induction butt welded tubes Grade-300	2700.00	KG
12	9.6	Steel work welded in built up sections/ framed work including cutting, hoisting, fixing in position and applying a priming coat of red oxide zinc chromate primer.		
	9.6.2	In gratings, frames, guard bar, ladder, railings, brackets, gates and similar works.	914.40	KG
13	9.15	Providing and fixing M.S. grill of approved pattern made of M.S. flats or square or round bars welded to steel frame of windows etc. including applying a priming coat welded to frame with all necessary fitting complete including applying a priming of red oxide zinc chromate primer.	525.00	KG
<b>ROOFING &amp; CEILING</b>				
14	10.24	Providing & fixing UV stabilized fibreglass reinforced plastic (FRP) sheet roofing upto any pitch including fixing with polymer coated 'J' or 'L' hooks, bolts & nuts 8mm dia. G.I plain/bitumen washers complete but excluding the cost of purlins, rafters, trusses etc. The sheets shall be manufactured out of 2400 TEX panel rovings incorporating minimum 0.3% Ultra-violet stabiliser in resin system under approximately 2400 psi and hot cured. They shall be of uniform pigmentation and thickness without air pockets and shall conform to IS 10192 and IS 12866. The sheets shall be opaque or translucent, clear or pigmented, textured or smooth as specified.		
	10.24.1	2mm thick corrugated (2.5" or 4.2" or 6") or step-down (2" or 3" or 6") as specified.	135.00	SQM.
<b>PLASTERING &amp; POINTING</b>				
15	11.1	Providing and making 6mm thick cement plaster of mix:		
	11.1.2	In Cement mortar 1:4 (1 cement : 4 fine sand)	174.38	SQM.
16	11.2	Providing and making 12mm thick cement plaster of mix:		
	11.2.4	In Cement Mortar 1:6 (1 cement : 6 fine sand)	32.04	SQM.
17	11.3	Providing and making 15mm thick cement plaster on the rough side of single or half brick wall of mix:		
	11.3.4	In Cement Mortar 1:6 (1 cement : 6 fine sand)	32.04	SQM.
18	11.7	Providing and making 18 mm thick cement plaster with under layer of 12mm thick cement plaster 1:5 (1 cement : 5 fine sand) finished with a top layer of 6mm thick cement plaster 1:3 (1 cement : 3 fine sand).	40.00	SQM.
<b>FLOORING</b>				
19	12.4	52 mm thick cement concrete flooring with under layer of 40mm thick cement concrete 1:2:4 (1 cement : 2 coarse sand : 4 graded stone aggregate 20mm nominal size) and top layer of 12 mm thick cement metallic hardener concrete mix 1:2 (1 cement hardener mix : 2 stone aggregate of 6 mm size by volume) with metallic hardening compound of approved quality mixed with cement in ratio of 4:1 (4 cement : 1 metallic floor hardening compound by weight) including finishing etc. complete.	100.00	SQM.
20	12.5	Extra for making chequers of approved pattern on cement concrete flooring, landing, pavement etc.	100.00	SQM.
21	12.6	Cement plaster skirting upto 30 cm. height with cement mortar 1:3 (1 cement : 3 fine sand) finished with a floating coat of neat cement including rounding of		
	12.6.1	18 mm thick in two layers of 12mm and 6mm	16.02	SQM.
<b>DISTEMPERING, PAINTING &amp; FINISHING</b>				
22	14.6	White washing with whitening to give an even shade.		
	14.6.1	On new work (Three or more coats)	278.46	SQM.

S.No	SOR NO.	ITEM DESCRIPTION	QUANTITY	UNIT
23	14.13	Providing and applying 2mm thick ready mix exterior grade approved make putty (like Birla wall care, Alltek Superfine W/R of (NCL), Asian, ICI, Nerolac, J.K. wall putty) on walls to make the surface smooth and even.	278.46	SQM.
24	14.16	Painting exterior surface with PREMIUM ACRYLIC SMOOTH exterior paint of required shade as per manufacturer's specifications to give protective and decorative finish including cleaning washing of surface etc. complete with:		
	14.16.1	On new work (Two or more coats applied @ 1.43 ltr/ 10 sqm over and including priming coat of exterior primer applied @ 2.20 kg/ 10 sqm)	278.46	SQM.
				SA

