

SECTION AT A-A

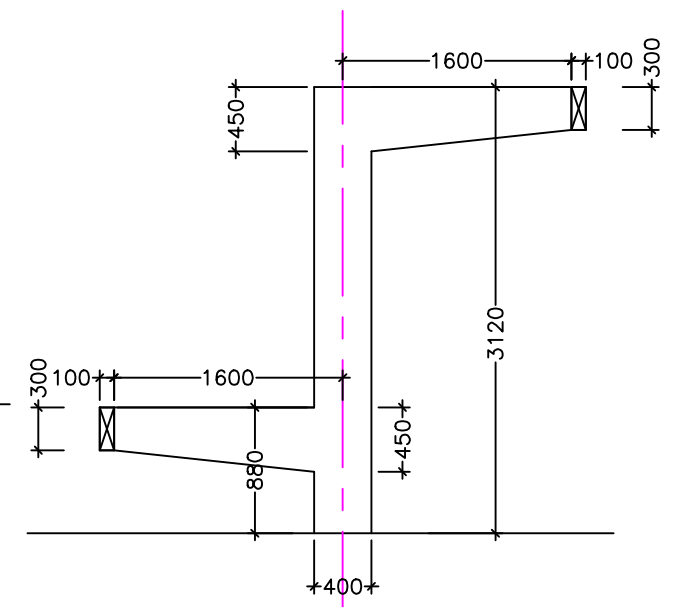

SECTION AT B-B

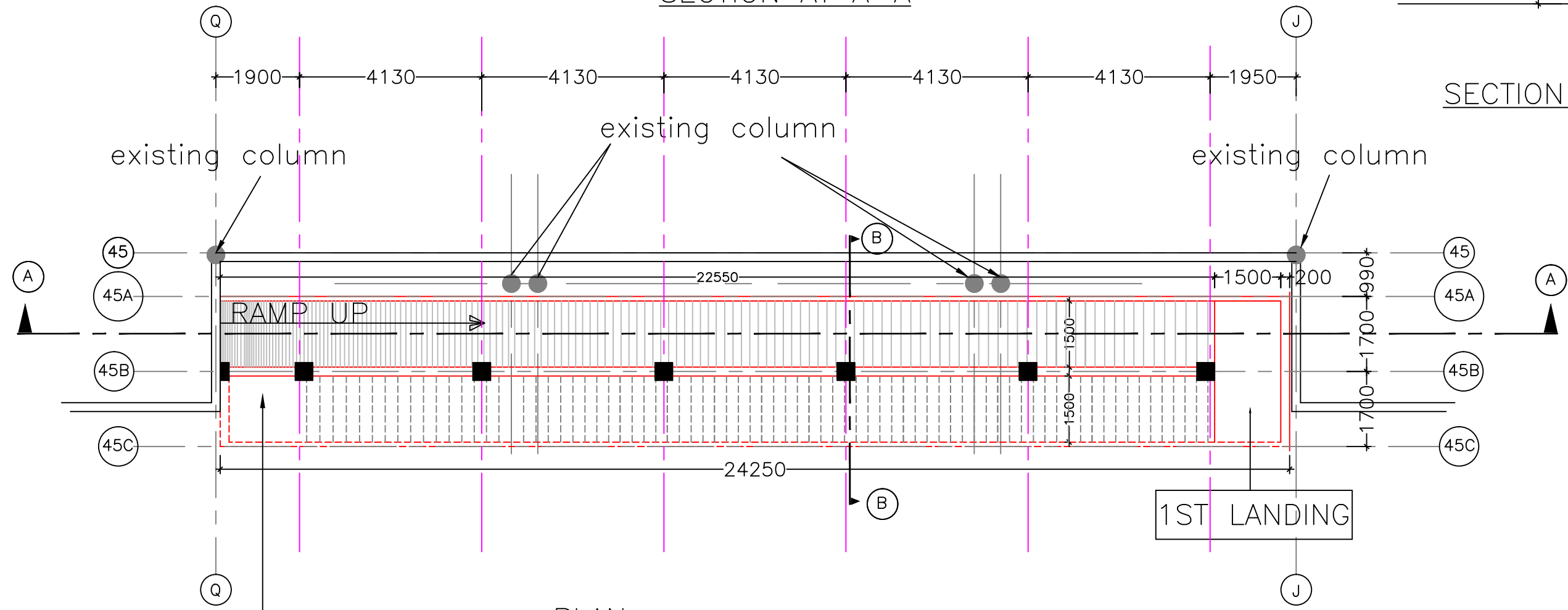

PLAN

RAMP DETAIL	MODERN CONSULTANTS
PROPOSED ACADEMIC CUM ADMINISTRATIVE BUILDING FOR INSTITUTE OF TECHNOLOGY, KORBA, CHHATTISGARH	12/16, NEHRU NAGAR(EAST), BHILAI. (C.G.) 9, ASHIRWAD BHAWAN, RAIPUR. (C.G.) architect: r.k.patel